

BASIC ROUND



Le linee pure e semplici della forma geometrica per eccellenza — il cerchio — la cui armonia si incontra con la luce con l'obiettivo di impreziosire ambienti e situazioni: Basic Round è un incasso a scomparsa totale in Coral® per installazione a soffitto di cartongesso o laterizio dal design unico e minimale, perfetto per illuminare gli spazi in modo discreto ed elegante.

Un apparecchio da interni adatto ad accogliere unicamente sorgenti luminose LED, retrocesse di 20 mm rispetto al filo del soffitto, che soddisfa qualsiasi esigenza progettuale ed esalta con naturalezza le superfici in cui l'apparecchio viene installato.

The pure and simple lines of the geometrical shape par excellence — the circle — whose harmony come together with light to enhance spaces and situations: Basic Round is a totally disappearing recessed luminaire made of Coral®, installable on plasterboard or brick ceilings with a unique and minimal design, perfect for illuminating spaces in a discreet and elegant way. Designed for the indoor, it can be only provided with LED luminescent sources positioned 20 mm backwards from the ceiling level. Basic Round suits any architectonic projects, spontaneously emphasizing the surfaces it is installed on.

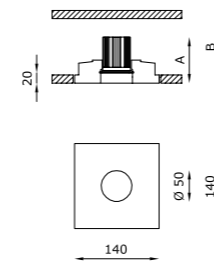

TECHNICAL FEATURES

Code	3121.00	3122.00	3123.Z.00
Type	Downlight 90° 	Downlight 90° 	Downlight 90°
Material	00: Coral®	00: Coral®	00: Coral®
Weight	0.7 Kg	0.7 Kg	0.8 Kg
Mounting	Ceiling recessed	Ceiling recessed	Ceiling recessed
IP rating	IP20	IP20	IP20
Insulation class	III	I	III
Control gear	Electronic transformer (not included)	-	Constant current electronic driver (not included)
Dimensions	A: 70 mm; B: 90 mm	A: 80 mm; B: 100 mm	A: 80 mm; B: 100 mm
Cut out for plasterboard	150 x 150 mm	150 x 150 mm	150 x 150 mm
Lamp type	QR CB 51 LED (optional) 	QPAR 16 LED (optional) 	LED 500 mA
Lamp wattage	-	-	1 x 10W
Luminous efficacy	-	-	105 lm/W - 3000K
Light distribution	-	-	Wide beam 40°
Fitting	GU5.3	GU10	-
Light colour	-	-	White 3000K White 2700K I 4000K (on request)
Light hole	Ø 50 mm	Ø 50 mm	Ø 50 mm
Voltage connection	220-240V / 12V · 50/60Hz	220-240V · 50/60Hz	220-240V · 50/60Hz
CRI	-	-	>80 >90 (on request)
Emergency	-	-	-
Energy efficiency class	A	A	A++
Note	-	-	On request available dimmable PUSH or DALI.

OPTIONAL ACCESSORIES

product code	optional code	description	info
3121.00	H8060	Dimmable electronic transformer	Max watt 60W Volts · Hz 230/12V · 50/60Hz
	0008KIT	Kit LED dimmable	Bulb 7W · 12V
	BR3121LT	Brick box	Dimensions L: 195 mm; W: 150 mm; D: 160 mm (instructions on page 524)
3122.00	0009KIT	Kit LED dimmable	Bulb 6W · 220-240V
	BR3122LT	Brick box	Dimensions L: 195 mm; W: 150 mm; D: 160 mm (instructions on page 524)
3123.Z.00	H8500.A	Constant current electronic driver. Remote installation	Suitable for n°2 code 3123.Z.00 - 500 mA
	H8500.B	Constant current electronic driver	Suitable for n°1 code 3123.Z.00 - 500 mA
	BR3123LT	Brick box	Dimensions L: 195 mm; W: 150 mm; D: 160 mm (instructions on page 524)



SUPERFUTUREDESIGN®



SUPERFUTUREDESIGN® - ph. A. Moggi